

ATLAS STAINLESS SUPPLIES pty Ltd

**T
h
e

F
a
b
r
i
c
a
t
o
r
s

H
a
n
d
b
o
o
k**

**T
h
e

F
a
b
r
i
c
a
t
o
r
s

H
a
n
d
b
o
o
k**



PH: 07 5593 4744

Fax: 07 5593 6205

6 Kimberley Rd

Burleigh Gardens Qld 4220

the leaders in supply of true grit finished stainless

www.atlasstainless.com.au

Materials

Round Welded Tube - 3
Square Welded Tube - 4
Rectangle Welded Tube - 4
Flat Bar - 5/6
Angle Bar - 6
Round Bar - 7/8
Square Bar - 8
Sheet - 9
Plate - 9
Pipe Schedule 10 - 10
Pipe Schedule 40 - 10

Weld on elbows

90 deg - 12
180 deg - 12
180 deg and tail - 12

Pre made posts

Wire balustrade post - 13
End Balustrade posts - 13
Wire spreader posts - 13
Pool fence glass post - 13

Caps

End cap weld on - 14
Post top only - 14
End cap push in - 14

Base plates

Round flange - 14
Oblong flange - 14
Covers and base plate - 15
Core hole covers - 15

Grabrail brackets

Screw on suit round - 16
Screw on suit square - 16
Weld on with base - 16
Weld on chemset to wall - 16
Glass handrail bracket - 18

Glass clamps

Spigotts - 17
Patch fittings - 17
"D" Shape clamps - 17
Pin panel connector - 18

Hinges

Self closing post to glass - 18
Self closing glass to glass - 18

Glass

Glass panels - 19

Wire rope

1x19 316 grade wire - 20
7x7 316 grade wire - 20
7x19 316 grade wire - 20

Wire rope fittings

Rigging screw - 21
Swage studs - 21
Fork terminals - 21
Saddles - 22
Eye bolts - 22
Eye nuts - 22

Fasteners

All thread - 23
Dome nuts - 23
Hex nuts - 23
Pop rivets - 23
Washers - 23
Self tappers - 24
Coach screw - 24
Bugle batten screw - 24
Hex bolts - 25

Abrasives

Flapper discs - 26
Velcro sanding disc - 26
Velcro sanding pad - 26
Grinding disc - 26
Cut off wheel - 26
Lining belts - 27
Pump up wheel belts - 27
Pump up wheel spares - 27

Polish equipment

Stitched sisal mops - 28
Stitched cloth mops - 28
Loose leaf mops - 28
Polish - 28

Installation equipment

Chemset - 29
Grout epoxy - 29
Sikaflex - 29
Silicone - 29

Safety equipment

Safety glasses - 29
Masks - 29
Gloves - 29
Ear plugs - 29

Services

Polishing service - 11
Fabrication shop - 31
Notching service - 30
Plasma cutting - 30



Round Welded Tube

Standard finish 320, 600HP, mirror

ASTM A554
ASTM A269
AS1528



Our in-house polishing facility can supply all grit finishes to 1000grit!!

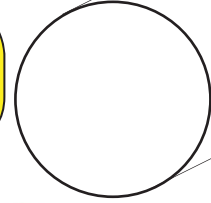

6.0 meter length

304 grade code	316 grade code	Size OD	Wall Thickness
RT6.35x0.9-304		6.35	0.9
RT6.35x0.7-304		6.35	0.7
RT7.94x0.9-304		7.94	0.9
RT9.53x1.6-304	RT9.53x1.6-316	9.53	1.6
RT9.53x1.2-304	RT9.53x1.2-316	9.53	1.2
RT12.7x1.6-304	RT12.7x1.6-316	12.7	1.6
RT12.7x1.2-304	RT12.7x1.2-316	12.7	1.2
RT15.9x1.6-304	RT15.9x1.6-316	15.9	1.6
RT15.9x1.2-304	RT15.9x1.2-316	15.9	1.2
RT19.05x1.6-304	RT19.05x1.6-316	19.05	1.6
RT19.05x1.2-304	RT19.05x1.2-316	19.05	1.2
RT19.05x0.9-304	RT19.05x0.9-316	19.05	0.9
RT22.2x1.6-304	RT22.2x1.6-316	22.2	1.6
RT22.2x1.2-304	RT22.2x1.2-316	22.2	1.2
RT25.4x1.6-304	RT25.4x1.6-316	25.4	1.6
RT25.4x1.2-304	RT25.4x1.2-316	25.4	1.2
RT28.6x1.6-304	RT28.6x1.6-316	28.6	1.6
RT28.6x1.2-304	RT28.6x1.2-316	28.6	1.2
RT31.8x1.6-304	RT31.8x1.6-316	31.8	1.6
RT31.8x1.2-304	RT31.8x1.2-316	31.8	1.2
RT38.1x1.6-304	RT38.1x1.6-316	38.1	1.6
RT38.1x1.2-304	RT38.1x1.2-316	38.1	1.2
RT44.4x1.6-304	RT44.4x1.6-316	44.4	1.6
RT44.4x1.2-304	RT44.4x1.2-316	44.4	1.2
RT50.8x2.0-304	RT50.8x2.0-316	50.8	2
RT50.8x1.6-304	RT50.8x1.6-316	50.8	1.6
RT50.8x1.2-304	RT50.8x1.2-316	50.8	1.2
RT63.5x1.6-304	RT63.5x1.6-316	63.5	1.6
RT63.5x1.2-304	RT63.5x1.2-316	63.5	1.2
RT76.2x2-304	RT76.2x2-316	76.2	2
RT76.2x1.6-304	RT76.2x1.6-316	76.2	1.6
RT88.9x1.6-304	RT88.9x1.6-316	88.9	1.6
RT101.6x1.6-304	RT101.6x1.6-316	101.6	1.6
RT127x1.6-304	RT127x1.6-316	127	1.6
RT152.4x1.6-304	RT152.4x1.6-316	152.4	1.6
RT203.2x1.6-304	RT203.2x1.6-316	203.2	1.6

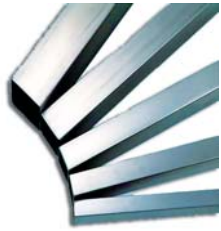

Square Welded Tube

Standard finish 180, 320, 600HP

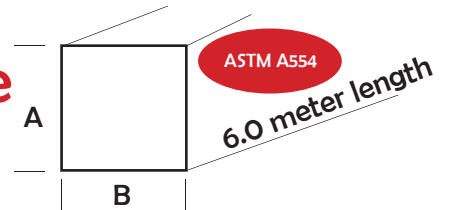

304 grade code	316 grade code	A	B	Wall
ST 12.7x12.7x0.9-304		12.7	12.7	0.9
ST 12.7x12.7x1.2-304		12.7	12.7	1.2
ST 19x19x1.2-304		19	19	1.2
ST 19x19x1.6-304		19	19	1.6
ST 22.2x22.2x1.2-304		22.2	22.2	1.2
ST 22.2x22.2x1.6-304	ST 22.2x22.2x1.6-316	22.2	22.2	1.6
ST25x25x2-304	ST25x25x2-316	25	25	2
ST25x25x3-304	ST25x25x3-316	25	25	3
ST 25.4x25.4x1.2-304	ST 25.4x25.4x1.2-316	25.4	25.4	1.2
ST 25.4x25.4x1.6-304	ST 25.4x25.4x1.6-316	25.4	25.4	1.6
ST 31.8x31.8x1.2-304	ST 31.8x31.8x1.2-316	31.8	31.8	1.2
ST 31.8x31.8x1.6-304	ST 31.8x31.8x1.6-316	31.8	31.8	1.6
ST32x32x2-304	ST32x32x2-316	32	32	2
ST32x32x3-304	ST32x32x3-316	32	32	3
ST38x38x3-304	ST38x38x3-316	38	38	3
ST 38.1x38.1x1.2-304	ST 38.1x38.1x1.2-316	38.1	38.1	1.2
ST 38.1x38.1x1.6-304	ST 38.1x38.1x1.6-316	38.1	38.1	1.6
ST50x50x3-304	ST50x50x3-316	50	50	3
ST 50.8x50.8x1.2-304	ST 50.8x50.8x1.2-316	50.8	50.8	1.2
ST 50.8x50.8x1.6-304	ST 50.8x50.8x1.6-316	50.8	50.8	1.6
ST80x80x3-304	ST80x80x3-316	80	80	3
ST100x100x3-304	ST100x100x3-316	100	100	3
ST100x100x5-304	ST100x100x5-316	100	100	5
ST150x150x5-304	ST150x150x5-316	150	150	5



Rectangle Welded Tube

Standard finish 180, 320, 600HP

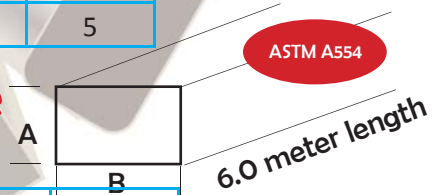

304 grade code	316 grade code	Width	Height	Wall
RECT20x10x1.6-304		20	10	1.6
RECT38.1x25.4x1.6-304	RECT38.1x25.4x1.6-316	38.1	25.4	1.6
RECT50.8x25.4x1.2-304	RECT50.8x25.4x1.2-316	50.8	25.4	1.2
RECT50.8x25.4x1.6-304	RECT50.8x25.4x1.6-316	50.8	25.4	1.6
RECT80x40x1.6-304	RECT80x40x1.6-316	80	40	1.6
RECT40x10x1.6-304		40	10	1.6
RECT50x10x1.6-304	RECT50x10x1.6-316	50	10	1.6
RECT50x25x3-304	RECT50x25x3-316	50	25	3
RECT60x40.1.6-304		60	40	1.6
RECT60x40x3-304	RECT60x40x3-316	60	40	3
RECT80x40x2-304		80	40	2
RECT80x40x3-304	RECT80x40x3-316	80	40	3
RECT100x50x3-304	RECT100x50x3-316	100	50	3
RECT150x100x5-304	RECT150x100x5-316	150	100	5



Flat Bar

Standard Mill finish
SRE & HRAP



Our in-house polishing facility can supply all grit finishes to 1000grit!!

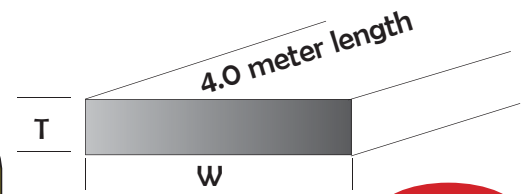

ASTM A276
ASTM A484M

304 grade code	316 grade code	Size(TxW)	Weight kg/m
FB3x12-304	FB3x12-316	3x12	0.317
FB3x20-304	FB3x20-316	3x20	0.48
FB3x25-304	FB3x25-316	3x25	0.63
FB3x30-304	FB3x30-316	3x30	0.79
FB3x40-304	FB3x40-316	3x40	0.948
FB3x50-304	FB3x50-316	3x50	1.3
FB3x75-304	FB3x75-316	3x75	1.98
FB5x20-304	FB5x20-316	5x20	0.79
FB5x25-304	FB5x25-316	5x25	0.987
FB5x30-304	FB5x30-316	5x30	1.19
FB5x40-304	FB5x40-316	5x40	1.58
FB5x50-304	FB5x50-316	5x50	1.97
FB5x65-304	FB5x65-316	5x65	2.56
FB5x75-304	FB5x75-316	5x75	2.96
FB6x12-304	FB6x12-316	6x12	0.648
FB6x150-304	FB6x150-316	6x150	7.38
FB6x20-304	FB6x20-316	6x20	0.97
FB6x25-304	FB6x25-316	6x25	1.3
FB6x30-304	FB6x30-316	6x30	1.6
FB6x40-304	FB6x40-316	6x40	1.93
FB6x50-304	FB6x50-316	6x50	2.59
FB6x65-304	FB6x65-316	6x65	3.25
FB6x75-304	FB6x75-316	6x75	3.89
FB6x100-304	FB6x100-316	6x100	5.18
FB8x40-304	FB8x40-316	8x40	3.3
FB8x50-304	FB8x50-316	8x50	4.3
FB8x75-304	FB8x75-316	8x75	4.95
FB8x100-304	FB8x100-316	8x100	5.58
FB10x20-304	FB10x20-316	10x20	1.58
FB10x25-304	FB10x25-316	10x25	1.97
FB10x30-304	FB10x30-316	10x30	2.43
FB10x40-304	FB10x40-316	10x40	3.16
FB10x50-304	FB10x50-316	10x50	3.96
FB10x65-304	FB10x65-316	10x65	5.13
FB10x75-304	FB10x75-316	10x75	5.93
FB10x100-304	FB10x100-316	10x100	7.9
FB10x150-304	FB10x150-316	10x150	11.83

Flat Bar

Standard Mill finish HRAP



304 grade code	316 grade code	Size(TxW)	Weight kg/m
FB12x100-304	FB12x100-316	12x100	10.36
FB12x25-304	FB12x25-316	12x25	2.59
FB12x30-304	FB12x30-316	12x30	3.25
FB12x40-304	FB12x40-316	12x40	3.89
FB12x50-304	FB12x50-316	12x50	5.18
FB12x65-304	FB12x65-316	12x65	6.48
FB12x75-304	FB12x75-316	12x75	7.77
FB16x40-304	FB16x40-316	16x40	5.05
FB16x50-304	FB16x50-316	16x50	6.48
FB16x65-304	FB16x65-316	16x65	8.21
FB20x100-304	FB20x100-316	20x100	15.8
FB20x50-304	FB20x50-316	20x50	7.9
FB20x75-304	FB20x75-316	20x75	11.9
FB25x100-304	FB25x100-316	25x100	20.69
FB25x50-304	FB25x50-316	25x50	10.36
FB25x75-304	FB25x75-316	25x75	15.48

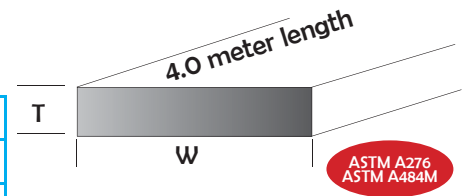

ASTM A276
ASTM A484M

Angle Bar

Standard Mill finish

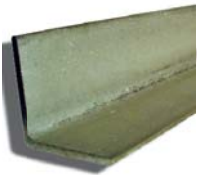

304 code	316 code	Size (WxAxB)	Weight
AB 3x20x20-304	AB 3x20x20-316	3x20x20	0.9kg/m
AB 3x25x25-304	AB 3x25x25-316	3x25x25	1.21kg/m
AB 3x30x30-304	AB 3x30x30-316	3x30x30	1.53kg/m
AB 3x40x40-304	AB 3x40x40-316	3x40x40	1.86kg/m
AB 3x50x50-304	AB 3x50x50-316	3x50x50	2.5kg/m
AB 4x30x30-304	AB 4x30x30-316	4x30x30	1.95kg/m
AB 4x40x40-304	AB 4x40x40-316	4x40x40	2.6kg/m
AB 5x25x25-304	AB 5x25x25-316	5x25x25	1.77kg/m
AB 5x30x30-304	AB 5x30x30-316	5x30x30	2.25kg/m
AB 5x40x40-304	AB 5x40x40-316	5x40x40	2.98kg/m
AB 5x50x50-304	AB 5x50x50-316	5x50x50	3.79kg/m
AB 6x100x100-304	AB 6x100x100-316	6x100x100	10.05kg/m
AB 6x25x25-304	AB 6x25x25-316	6x25x25	2.26kg/m
AB 6x30x30-304	AB 6x30x30-316	6x30x30	2.92kg/m
AB 6x40x40-304	AB 6x40x40-316	6x40x40	3.56kg/m
AB 6x50x50-304	AB 6x50x50-316	6x50x50	4.95kg/m
AB 6x65x65-304	AB 6x65x65-316	6x65x65	6.16kg/m
AB 6x75x75-304	AB 6x75x75-316	6x75x75	7.46kg/m
AB 10x100x100-304	AB 10x100x100-316	10x100x100	15kg/m
AB 10x150x150-304	AB 10x150x150-316	10x150x150	23.7kg/m
AB 10x50x50-304	AB 10x50x50-316	10x50x50	7.06kg/m
AB 10x65x65-304	AB 10x65x65-316	10x65x65	9.48kg/m
AB 10x75x75-304	AB 10x75x75-316	10x75x75	11.1kg/m
AB 12x100x100-304	AB 12x100x100-316	12x100x100	19.6kg/m

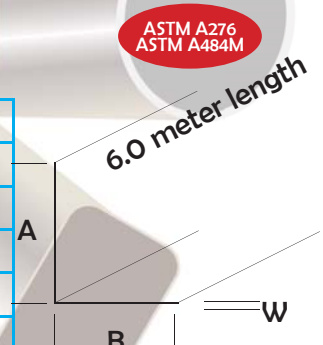

ASTM A276
ASTM A484M



Round Bar

Standard Mill finish



Our in-house polishing facility can supply all grit finishes to 1000grit!!

Dia

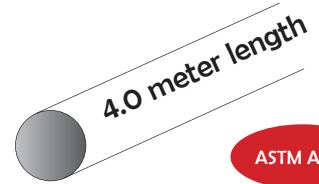

ASTM A276

304 grade code	316 grade code	Size (Dia)	Weight/m
RB 3.18-304	RB 3.18-316	3.18	0.062
RB 3.96-304	RB 3.96-316	3.96	0.1
RB 4.76-304	RB 4.76-316	4.76	0.14
RB 5-304	RB 5-316	5	0.155
RB 6-304	RB 6-316	6	0.23
RB 6.35-304	RB 6.35-316	6.35	0.25
RB 7.94-304	RB 7.94-316	7.94	0.39
RB 8-304	RB 8-316	8	0.4
RB 9.53-304	RB 9.53-316	9.53	0.56
RB 10-304	RB 10-316	10	0.62
RB 11.11-304	RB 11.11-316	11.11	0.76
RB 12-304	RB 12-316	12	0.89
RB 12.7-304	RB 12.7-316	12.7	0.99
RB 14.28-304	RB 14.28-316	14.28	1.26
RB 15.88-304	RB 15.88-316	15.88	155.2
RB 16-304	RB 16-316	16	1.58
RB 19.05-304	RB 19.05-316	19.05	2.235
RB 20-304	RB 20-316	20	2.47
RB 22.23-304	RB 22.23-316	22.23	3.042
RB 24-304	RB 24-316	24	3.551
RB 25-304	RB 25-316	25	3.853
RB 25.4-304	RB 25.4-316	25.4	3.973
RB 28.58-304	RB 28.58-316	28.58	5.03
RB 30-304	RB 30-316	30	5.55
RB 31.75-304	RB 31.75-316	31.75	6.21
RB 33-304	RB 33-316	33	6.72
RB 34.93-304	RB 34.93-316	34.93	7.512
RB 35-304	RB 35-316	35	7.553
RB 36-304	RB 36-316	36	8
RB 38.1-304	RB 38.1-316	38.1	8.94
RB 40-304	RB 40-316	40	9.87
RB 41.28-304	RB 41.28-316	41.28	10.5
RB 44.45-304	RB 44.45-316	44.45	12.17
RB 50-304	RB 50-316	50	15.413
RB 50.8-304	RB 50.8-316	50.8	15.9
RB 53.97-304	RB 53.97-316	53.97	17.95
RB 57.15-304	RB 57.15-316	57.15	20.12



Round Bar Cont.

Standard Mill finish



Dia



4.0 meter length

ASTM A276

304 grade code	316 grade code	Size (Dia)	Weight/m
RB 60-304	RB 60-316	60	22.2
RB 63.5-304	RB 63.5-316	63.5	24.84
RB 69.85-304	RB 69.85-316	69.85	30.05
RB 76.2-304	RB 76.2-316	76.2	35.76
RB 82.55-304	RB 82.55-316	82.55	41.98
RB 88.9-304	RB 88.9-316	88.9	48.68
	RB 95.25-316	95.25	55.88
RB 101.6-304	RB 101.6-316	101.6	63.59
RB 114.3-304	RB 114.3-316	114.3	81.9
RB 127-304	RB 127-316	127	100.9
	RB 139.7-316	139.7	122.5
RB 152.4-304	RB 152.4-316	152.4	144.9
	RB 177.8-316	177.8	196.9
RB 203.2-304	RB 203.2-316	203.2	256.8

Square Bar

Standard Mill finish



Our in-house polishing facility can supply all grit finishes to 1000grit!!

A

4.0 meter length

B

ASTM A276
ASTM A582
ASTM A484M

314 code	316 code	Size(AxB)	Weight Kg/m
SB4x4-304	SB4x4-316	4x4	0.13
SB6x6-304	SB6x6-316	6x6	0.33
SB6.35x6.35-304	SB6.35x6.35-316	6.35x6.35	0.34
SB8x8-304	SB8x8-316	8x8	0.53
SB9.52x9.52-304	SB9.52x9.52-316	9.52x9.52	0.75
SB10x10-304	SB10x10-316	10x10	0.8
SB12x12-304	SB12x12-316	12x12	1.27
SB12.7x12.7-304	SB12.7x12.7-316	12.7x12.7	1.32
SB15.88x15.88-304	SB15.88x15.88-316	15.88x15.88	2.03
SB16x16-304	SB16x16-316	16x16	2.05
SB19.05x19.05-304	SB19.05x19.05-316	19.05x19.05	2.98
SB20x20-304	SB20x20-316	20x20	3.21
SB25x25-304	SB25x25-316	25x25	5.18
SB25.4x25.4-304	SB25.4x25.4-316	25.4x25.4	5.29
SB32x32-304	SB32x32-316	32x32	8.21
SB38.1x38.1-304	SB38.1x38.1-316	38.1x38.1	11.9
SB40x40-304	SB40x40-316	40x40	12.83
SB45x45-304	SB45x45-316	45x45	16.24
SB50x50-304	SB50x50-316	50x50	20.05
SB50.8x50.8-304	SB50.8x50.8-316	50.8x50.8	21.2

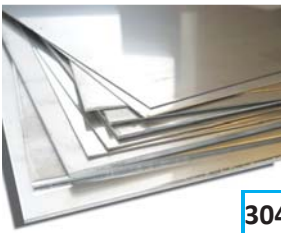

Sheet

2B & NO.4 finishes

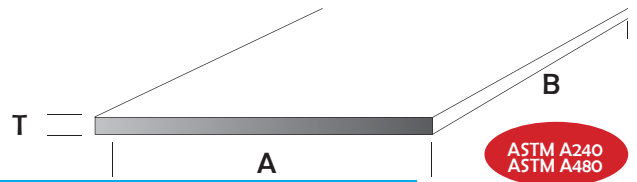

ASTM A240
ASTM A480

304 grade code	316 grade code	Thickness(T)	Size(AxB)
SH0.55x1219x2438	SH0.55x1219x2438-316	0.55	1219x2438
SH0.7x1219x2438	SH0.7x1219x2438-316	0.7	1219x2438
SH0.9x1219x2438	SH0.9x1219x2438-316	0.9	1219x2438
SH1.2x1219x2438	SH1.2x1219x2438-316	1.2	1219x2438
SH1.2x3000x1500	SH1.2x3000x1500-316	1.2	3000x1500
SH1.5x915x1819	SH1.5x915x1819-316	1.5	915x1819
SH1.5x1219x2438	SH1.5x1219x2438-316	1.5	1219x2438
SH1.5x1219x3000	SH1.5x1219x3000-316	1.5	1219x3000
SH1.5x1500x3000	SH1.5x1500x3000-316	1.5	1500x3000
SH2.0x1219x2438	SH2.0x1219x2438-316	2	1219x2438
SH2.0x1219x3000	SH2.0x1219x3000-316	2	1219x3000
SH2.0x1500x3000	SH2.0x1500x3000-316	2	1500x3000
SH2.5x1219x2438	SH2.5x1219x2438-316	2.5	1219x2438
SH2.5x1219x3000	SH2.5x1219x3000-316	2.5	1219x3000
SH2.5x1500x3000	SH2.5x1500x3000-316	2.5	1500x3000
SH3.0x1219x2438	SH3.0x1219x2438-316	3	1219x2438
SH3.0x1219x3000	SH3.0x1219x3000-316	3	1219x3000
SH3.0x1500x3000	SH3.0x1500x3000-316	3	1500x3000

Our in-house plasma cutting service available up to 16mm

Plate

Standard 2B & Mill finish

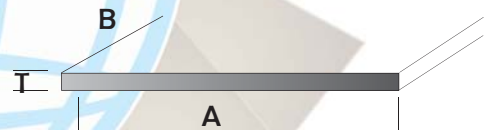

ASTM A240
ASTM A480

304 grade code	316 grade code	Thickness (T)	Size (AxB)
PL3.0x1219x2438-304	PL3.0x1219x2438-316	3	1219x2438
PL3.0x1500x3000-304	PL3.0x1500x3000-316	3	1500x3000
PL4.0x1219x2438-304	PL4.0x1219x2438-316	4	1219x2438
PL4.0x1500x3000-304	PL4.0x1500x3000-316	4	1500x3000
PL5.0x1219x2438-304	PL5.0x1219x2438-316	5	1219x2438
PL5.0x1500x3000-304	PL5.0x1500x3000-316	5	1500x3000
PL6.0x1219x2438-304	PL6.0x1219x2438-316	6	1219x2438
PL6.0x1500x3000-304	PL6.0x1500x3000-316	6	1500x3000
PL8.0x1219x2438-304	PL8.0x1219x2438-316	8	1219x2438
PL8.0x1500x3000-304	PL8.0x1500x3000-316	8	1500x3000
PL10x1219x2438-304	PL10x1219x2438-316	10	1219x2438
PL10x1500x3000-304	PL10x1500x3000-316	10	1500x3000
PL12x1219x2438-304	PL12x1219x2438-316	12	1219x2438
PL12x1500x3000-304	PL12x1500x3000-316	12	1500x3000
PL16x1500x3000-304	PL16x1500x3000-316	16	1500x3000
PL20x1500x3000-304	PL20x1500x3000-316	20	1500x3000
PL25x1500x3000-304	PL25x1500x3000-316	25	1500x3000
PL32x1500x3000-304	PL32x1500x3000-316	32	1500x3000
PL40x1500x3000-304	PL40x1500x3000-316	40	1500x3000
PL50x1500x3000-304	PL50x1500x3000-316	50	1500x3000





Pipe Schedule 10

Standard Annealed & Pickled finish

ASTM A312
ASTM 94B

Our in-house polishing facility can supply all grit finishes to 1000grit!!

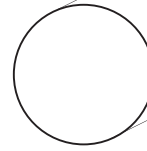

6.1 meter length



304L grade code	316L grade code	NB Pipe Size inch	NB Pipe size mm	OD	Wall	Weight
PIW1/8-10-304	PIW1/8-10-316	1/8	6	10.287	1.244	0.27
PIW1/4-10-304	PIW1/4-10-316	1/4	8	13.716	1.651	0.5
PIW3/8-10-304	PIW3/8-10-316	3/8	10	17.145	1.651	0.62
PIW1/2-10-304	PIW1/2-10-316	1/2	12	21.336	2.108	1
PIW3/4-10-304	PIW3/4-10-316	3/4	20	26.67	2.108	1.26
PIW1-10-304	PIW1-10-316	1	25	33.401	2.768	2.08
PIW1 1/4-10-304	PIW1 1/4-10-316	1 1/4	32	42.164	2.768	2.68
PIW1 1/2-10-304	PIW1 1/2-10-316	1 1/2	40	48.26	2.768	3.1
PIW2-10-304	PIW2-10-316	2	50	60.325	2.768	3.9
PIW2 1/2-10-304	PIW2 1/2-10-316	2 1/2	65	73.035	3.048	5.35
PIW3-10-304	PIW3-10-316	3	75	88.9	3.048	6.45
PIW3 1/2-10-304	PIW3 1/2-10-316	3 1/2	90	101.6	3.048	7.39
PIW4-10-304	PIW4-10-316	4	100	114.3	3.048	8.35
PIW5-10-304	PIW5-10-316	5	125	141.3	3.403	11.56
PIW6-10-304	PIW6-10-316	6	150	168.275	3.403	13.8



Pipe Schedule 40

Standard Annealed & Pickled finish

ASTM A554
ASTM A269
ASTM 528



6.1 meter length

304L grade code	316L grade code	NB Pipe Size inch	NB Pipe size mm	OD	Wall	Weight/m
PIW1/8-40-304	PIW1/8-40-316	1/8	6	10.287	1.727	0.36
PIW1/4-40-304	PIW1/4-40-316	1/4	8	13.716	2.235	0.632
PIW3/8-40-304	PIW3/8-40-316	3/8	10	17.145	2.311	0.845
PIW1/2-40-304	PIW1/2-40-316	1/2	12	21.336	2.768	1.26
PIW3/4-40-304	PIW3/4-40-316	3/4	20	26.67	2.87	1.682
PIW1-40-304	PIW1-40-316	1	25	33.401	3.378	2.498
PIW1 1/4-40-304	PIW1 1/4-40-316	1 1/4	32	42.164	3.556	3.382
PIW1 1/2-40-304	PIW1 1/2-40-316	1 1/2	40	48.26	3.683	4.044
PIW2-40-304	PIW2-40-316	2	50	60.325	3.911	5.435
PIW2 1/2-40-304	PIW2 1/2-40-316	2 1/2	65	73.035	5.156	8.61
PIW3-40-304	PIW3-40-316	3	75	88.9	5.486	11.27
PIW3 1/2-40-304	PIW3 1/2-40-316	3 1/2	90	101.6	5.74	13.55
PIW4-40-304	PIW4-40-316	4	100	114.3	6.019	16.05
PIW5-40-304	PIW5-40-316	5	125	141.3	6.553	21.75
PIW6-40-304	PIW6-40-316	6	150	168.275	7.112	28.22

All sizes of pipe fittings available on request!!



ATLAS STAINLESS SUPPLIES pty Ltd

the leaders in supply of true grit finished stainless



Polishing Service

Our in-house polishing facility can supply all grit finishes to 1000grit!!



- *Polishing up to 1000grit
- *Round Tube
- *Flat bar
- *Square Tube
- *Rectangle Tube

- *Angle
- *Round Bar
- *Square Bar
- *Sizes up to 150 x 150
- *Pipe up to 250NB
- *Cut parts can be polished

Weld on tube elbow 90 deg

Standard No 4 & 600HP finish

304 grade code	316 grade code	Suit tube size
	ELB1/2x1.6-90	12.7 (1/2) x 1.6
	ELB5/8x1.6-90	15.9 (5/8)x 1.6
ELB3/4x1.6-90-304	ELB3/4x1.6-90	19.05(3/4) x 1.6
ELB1x1.6-90-304	ELB1x1.6-90	25.4 (1)x 1.6
ELB11/4x1.6-90-304	ELB11/4x1.6-90	31.8 (1 1/4)x 1.6
ELB11/2x1.6-90-304	ELB11/2x1.6-90	38.1 (1 1/2)x 1.6
	ELB13/4x1.6-90	44.4 x (1 3/4)1.6
ELB2x1.6-90-304	ELB2x1.6-90	50.8 (2)x 1.6
ELB21/2x1.6-90-304	ELB21/2x1.6-90	63.5 (2 1/2)x 1.6
ELB3x1.6-90-304	ELB3x1.6-90	76.2 (3)x 1.6
	ELB31/2x1.6-90	88.9 (3 1/2)x 1.6
ELB4x1.6-90-304	ELB4x1.6-90	101.6 (4)x 1.6

Weld on tube elbow 180 deg

Standard No 4 & 600HP finish

316 grade code	Size
ELB1/2x1.6-180	1/2x1.6
ELB5/8x1.6-180	5/8x1.6
ELB3/4x1.6-180	3/4x1.6
ELB1x1.6-180	1x1.6
ELB11/4x1.6-180	1 1/4x1.6
ELB11/2x1.6-180	1 1/2x1.6
ELB13/4x1.6-180	1 3/4x1.6
ELB2x1.6-180	2x1.6
ELB21/2x1.6-180	2 1/2x1.6
ELB3x1.6-180	3x1.6
ELB31/2x1.6-180	3 1/2x1.6
ELB4x1.6-180	4x1.6

Weld on tube 180 deg and tail

Standard No 4 & 600HP finish

304 grade code	316 grade code	Suit tube size
ELBT2x1.6-304	ELBT2x1.6-316	50.8 x 1.6

316 grade wire balustrade post

Standard 600 H/P finish



Our in-house fabrication workshop can supply posts to your specifications, with all bases, all sizes!!

Code	Post Dia	L	T	B	C	Hole dia
H050111	50.8 x 1.6	960	50	30	80	5

316 grade wire Spreader post

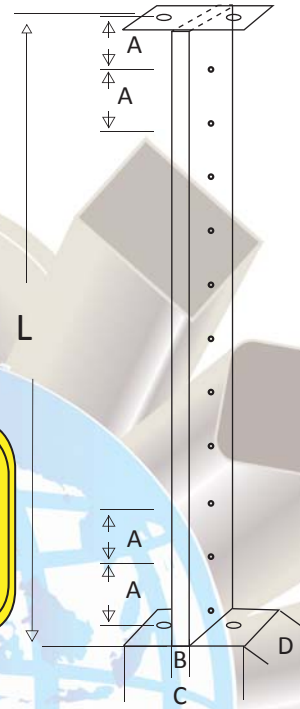

Code	L	A	B	C	D	Hole dia
H050113	960	80	5	40	40	5

316 grade end post to suit saddles

Standard 600 H/P finish

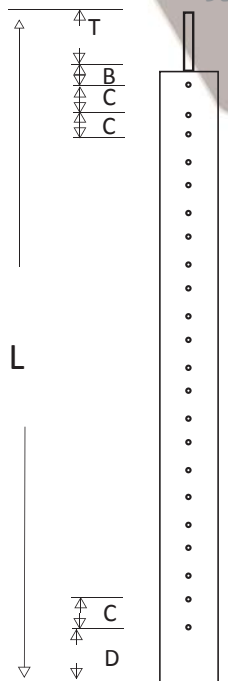

Our in-house fabrication workshop can supply posts to your specifications, with all bases, all sizes!!

316 post with glass clamps welded on

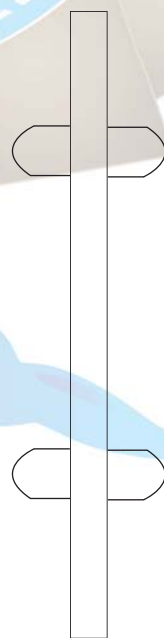

Code	L	D	Glass	# Clamps	Type	Suit
H050114	960	50.8	up to 12	2	End	Balustrade
H050115	960	50.8	up to 12	4	Intermediate	Balustrade
H050116	1210	50.8	up to 12	2	End	Pool Fence
H050117	1210	50.8	up to 12	4	Intermediate	Pool Fence

Code	Post Dia	L	T	B	C	D	Hole dia
H050112	50.8 x 1.6	960	50	10	40	65	3

Weld on 316 end caps

Standard 2B finish



Code	Suit Tube	Thickness
HWEC38	38 OD	3mm
HWEC38	50.8 OD	3mm

All sizes available on request!!

316 post tops only

Standard 2B finish



Code	Suit Tube	ID
HT38	38 OD	12mm
HT50-12	50.8 OD	12mm
HT50-16	50.8 OD	16mm

Push in End Cap

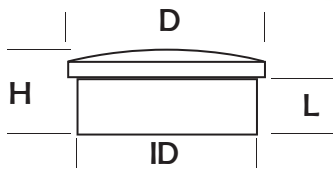

Code	D	H	L	ID
H16PEC25	25	13	8	22
H16PEC32	32	18	12.5	29
H16PEC38	38	15	10	35
H16PEC50	51	16	10	48
H16PEC63	63	17	12	60
H16PEC76	76	22	12	76
H16PEC101	101	20	10	98

Round flange

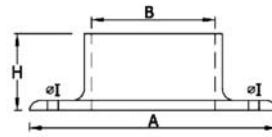

Code	Suit Tube	A	B	H	I
H050109	50.8 OD	102	50.8	31	9

Oblong flange

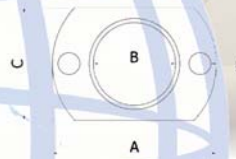

Code	Suit Tube	A	B	C	I
H052509	50.8 OD	100	50.8	69	9

Adjustable foot

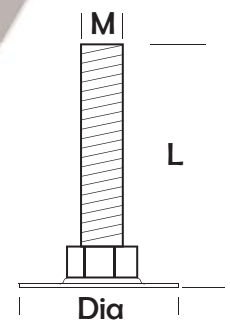

Code	Dia	M	L
HBD55	55	M10x50	60
HBD65	65	M12x50	68
HBD80	80	M16x60	84

Standard Base plate and cover sets

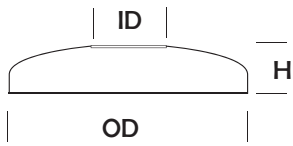

Code	OD	ID	H	TH
H16BCP13	67	13	15	1
H16BCP19	67	19	15	1
H16BCP25	67	25	15	1
H16BCP32	82	32	17	1
H16BCP38	82	38	17	1
H16BCP50	102	51	25	1
H16BCP50M	102	51	25	1
H16BCP63	117	63.5	28	1
H16BCP76	117	76	27	1

Standard Base plates Only

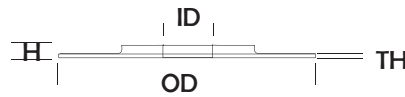

Code	OD	ID	H	TH
H04BP13	65	13	6	2
H04BP19	65	19	5.5	2
H04BP25	65	25	5.5	2
H04BP32	80	32	6.5	2
H04BP38	80	38	6	2
H04BP50	100	51	8	3
H04BP63	115	63.5	8	3
H04BP76	115	76	6	6

Covers only suit HD and standard bases

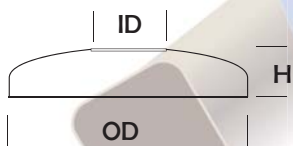

Code	OD	ID	H	TH
H16CP13	67	13	15	1
H16CP19	67	19	15	1
H16CP25	67	25	15	1
H16CP32	82	32	17	1
H16CP38	82	38	17	1
H16CP50	102	51	25	1
H16CP50M	102	51	25	1
H16CP63	117	63.5	28	1
H16CP76	117	76	27	1

Heavy Duty base plates

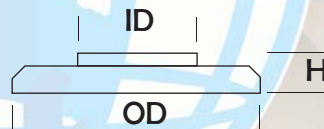

Code	OD	ID	H
H16FL51	99	51.8	10
H16FL51M	99	51.8	10
H16FL12	70	12	7.5
H16FL12M	70	12	7.5

Round tube covers

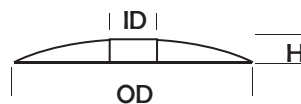

Code	OD	ID	H
H163TC1.5	79	38	7
H164TC1.5	101	52	9
H164TC1.5M	101	52	9

Square tube covers

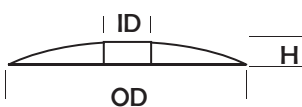

Code	OD	ID	H
H163TCSQ1.5	76.2	38.2	7
H164TCSQ1.5	102	51.5	9.5

Handrail bracket for tube Handrail bracket weld on

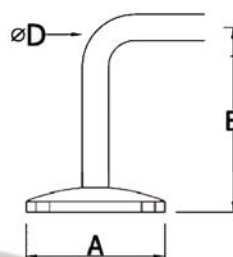
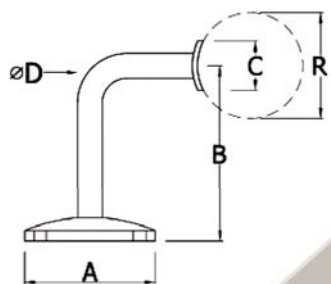

Code	Suits toprail	A	B	C	D
H092909	45-55 round	63	85	31	12

Code	Suits toprail	A	B	D
H094500	All surfaces	63	85	12

Handrail bracket for flat surfaces Weld on grabrail bracket with cover ring

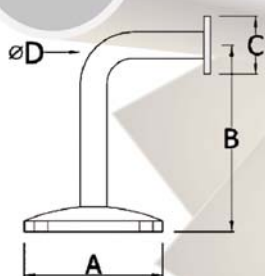

Code	Suits toprail	A	B	C	D
H094501	flat/square	63	85	31	12

Code	Suits toprail	A	B	D
H094502	All surfaces	63	85	12

Ball Railing Joint



Code	Description	DIA	D1	D2	TH
H04RJS2	Ball joint Single 50.8mm Hole	80	50.8		1.6
H04RJS1.5	Ball Joint Single 38mm Hole	80	38		1.6
H04RJD2-1.5	Ball Joint 2 hole 50.8-38	80	50.8	38	1.6
H04RJD1.5-1.5	Ball Joint 2 hole 38-38	80	38	38	1.6
H04RJD2-2	Ball Joint 2 hole 50.8-50.8	80	50.8	50.8	1.6

Spigot Square



Code	Suit Glass	Finish
SPIGOTSQM	12mm	Mirror
SPIGOTSQS	12mm	Satin

Spigot Round



Code	Suit Glass	Finish
SPIGOTRNDM	12mm	Mirror
SPIGOTRNS	12mm	Satin

Patch Fittings



Code	D	O	Suit Glass	Finish
SPF38M	38	30	10-17mm	Mirror
SPF38S	38	30	10-17mm	Satin
SPF50M	50	38	10-17mm	Mirror
SPF50S	50	38	10-17mm	Satin

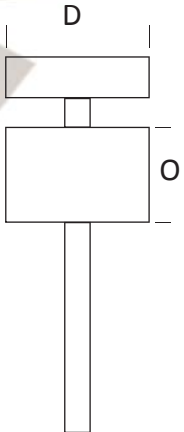

Glass Clamp Dee

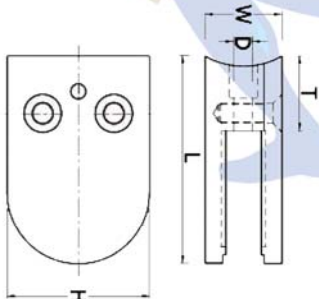

Code	Suit Tube	H	L	W	T	D
H100901	Flat/Square	45	63	26	16	9
H100909	2" Round	45	63	26	26	9
H100006	Rubbers suit 6mm glass				2 per clamp	
H100008	Rubbers suit 8mm glass				2 per clamp	
H100010	Rubbers suit 10mm glass				2 per clamp	

Glass pin panel connector



Code	Suits Glass	A	B	C	Glass hole size
HRD38	12-24mm	10	10	38	14
HRD50	12-24mm	10	10	50	14

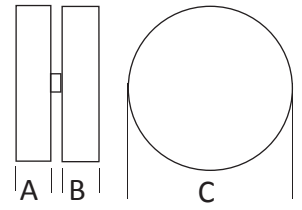

Glass handrail bracket

Code	Suits Glass	Glass hole size
HRBGF	10-24mm	14
HRBGS	10-24mm	14
HRBGR	10-24mm	14



Our in-house fabrication workshop can produce all styles of brackets!!

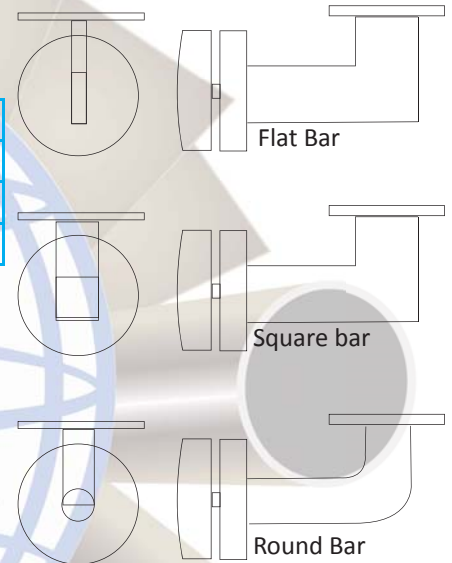

Self closing hinges post-glass, glass-glass



Code	Suits Glass	
HINGEPG	8-12mm	Post-Glass
HINGEGG	8-12mm	Glass-Glass



Glass Panels

All glass panelling available, pre cut and polished edges!



- *All sizes available 6mm & up
- *Toughened glass
- *Laminated glass
- *Toughened/Laminated glass
- *Tinted
- *Acid etched

- *Slumped
- *Float
- *Polished edges
- *High quality
- *Great prices
- *National delivery

Wire Rope 1x19 305m roll

Least flexible wire rope

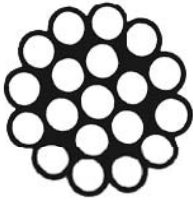

Code	Size	Breaking Kg	KG/100m
WR332119	3/32" (2.5mm)	484	3.10
WR18119	1/8" (3.2mm)	861	4.47
WR532119	5/32" (4.0mm)	1340	7.95
WR316119	3/16" (4.8mm)	1930	12.40
WR14119	1/4" (6.4mm)	3440	17.90
WR516119	5/16" (8.0mm)	5380	31.8
WR38119	3/8" (9.5mm)	7580	49.70
WR12119	1/2" (12.7mm)	14200	71.30

Wire Rope 7x7 305m roll

Semi flexible wire rope



Code	Size	Breaking Kg	KG/100m
WR33277	3/32" (2.5mm)	332	2.60
WR1877	1/8" (3.2mm)	652	3.85
WR53277	5/32" (4.0mm)	1030	7.00
WR31677	3/16" (4.8mm)	1493	10.50
WR1477	1/4" (6.4mm)	2642	14.80
WR51677	5/16" (8.0mm)	4140	25.5
WR3877	3/8" (9.5mm)	5830	38.8
WR1277	1/2" (12.7mm)	10900	65.5

Wire Rope 7x19 305m roll

Flexible wire rope

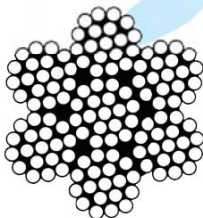

Code	Size	Breaking Kg	KG/100m
WR332719	3/32" (2.5mm)	323	3.10
WR18719	1/8" (3.2mm)	602	4.47
WR532719	5/32" (4.0mm)	956	7.95
WR316719	3/16" (4.8mm)	1373	12.40
WR14719	1/4" (6.4mm)	2450	17.90
WR516719	5/16" (8.0mm)	3820	31.8
WR38719	3/8" (9.5mm)	5388	49.70
WR12719	1/2" (12.7mm)	9628	71.30

Jaw-Swage bottlescrew

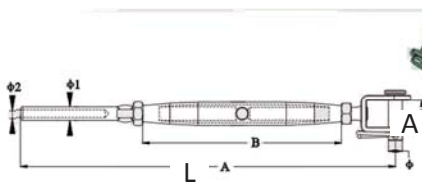

Code	Size	Wire Size	L	A	Pin
S312T-503MINI	5.0	3.2	108.0	7.0	5.0
S312T-503	5.0	3.2	155.0	7.0	5.0
S312T-603	6.0	3.2	176.0	8.0	6.0
S312T-604	6.0	4.0	176.0	8.0	6.0
S312T-805	8.0	5.0	223.0	11.0	8.0
S312T-106	10.0	6.4	245.0	15.0	10.0
S312T-128	12.0	8.0	300.0	17.0	12.0

Stud Terminals

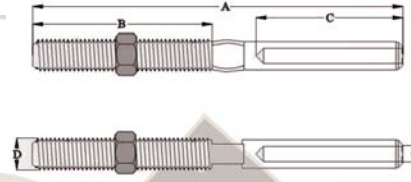

Code	Wire Size	A	B	C
S7801-0025	2.5	86.0	40.0	35.0
S7801-0532	3.2	90.0	40.0	40.0
S7801-0532L	3.2	90.0	40.0	40.0
S7801-0632	3.2	95.0	45.0	40.0
S7801-0632L	3.2	95.0	45.0	40.0
S7801-0632XL	3.2	130.0	85.0	40.0
S7801-0640	4.0	102.0	45.0	45.0
S7801-0640L	4.0	102.0	45.0	45.0
S7801-0040	4.0	120.0	60.0	48.0
S7801-0040L	4.0	120.0	60.0	48.0
S7801-0805	5.0	125.0	60.0	53.0
S7801-0805L	5.0	125.0	60.0	53.0
S7801-0050	5.0	135.0	65.0	58.0
S7801-1064	6.4	144.0	65.0	65.0
S7801-1264	6.4	160.0	79.0	65.0
S7801-1208	8.0	180.0	79.0	83.0
S7801-0080	8.0	231.0	102.0	97.0

Fork Terminals

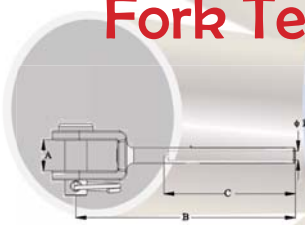

Code	Wire Size	Pin Size	A	B
S7803-0025	2.5	5.0	6.5	55.0
S7803-030MINI	3.2	5.0	7.5	45.0
S7803-0305	3.2	5.0	7.5	65.0
S7803-0406	4.0	6.0	10.0	77.0
S7803-0040	4.0	8.0	10.0	77.0
S7803-0050	5.0	8.0	12.0	88.0
S7803-0060	6.4	12.0	14.0	106.0
S7803-0080	8.0	14.0	15.0	145.0

Jaw - Jaw Bottlescrew

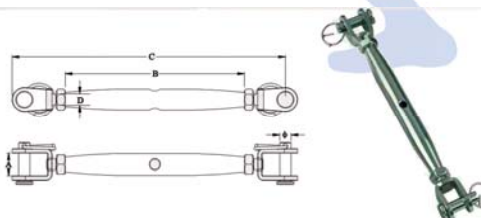

Our in-house swaging service can supply pre made cables with any fittings to your specifications!!

Code	Size	Pin	A	C
S312-0050	5.0	5.0	10.5	125.0
S312-0060	6.0	5.0	10.5	140.0
S312-0080	8.0	8.0	11.5	170.0
S312-0100	10.0	10.0	15.5	190.0
S312-0120	12.0	12.0	19.2	240.0

Saddle

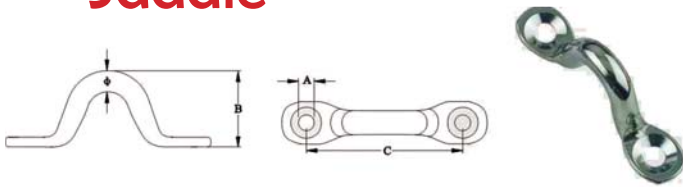

Code	Size	A	B	C
S322-0050	5	4.2	17.5	40.0
S322-0060	6	5.2	22.5	45.0
S322-0080	8	5.2	23.0	50.0

Eye bolt short

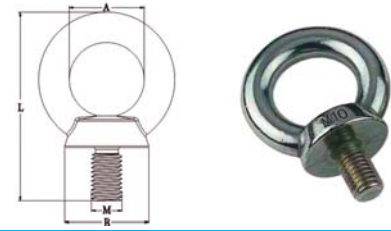

Code	Size	A	B	L
S580-0060	6	16	18.5	41.0
S580-0080	8	20	21.5	49.5
S580-0100	10	25	27.0	61.5
S580-0120	12	30	33.0	75.0
S580-0160	16	35	40.0	91.5
S580-0200	20	40	44.5	104.5
S580-0240	24	50	57.0	126.5
S580-0300	30	50	67.0	153.0

Eye bolt



Code	Size	A	B	C
S444-612	M6	6.5	7.0	10.0
S444-625	M6	6.5	7.0	16.0

Screw eye



Code	Dia	L	A	B
S3182-06060	6.0	60.0	6.3	7.0
S3182-06080	8.0	60.0	8.4	9.0
S3182-10080	10.0	80.0	10.2	11.0
S3182-12100	12.0	100.0	12.1	13.0

Eye bolt long

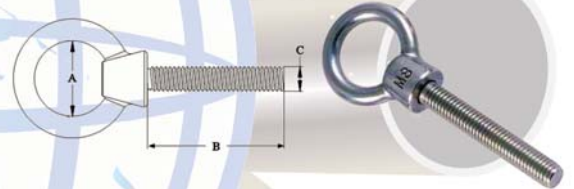

Code	Size	A	B
S306ML-1250	M12	30.0	100.0
S306ML-1650	M16	35.0	130.0



Our in-house fabrication workshop can supply any length in any size!!

Welded eye bolt

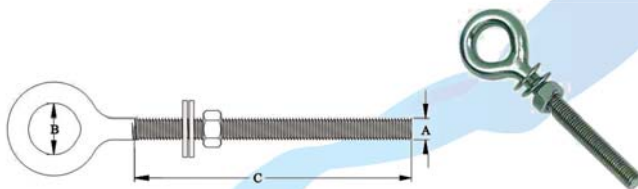

Code	Dia	L	A	B
S3191-06040	6.0	40.0	M6	13.0
S3191-06060	6.0	60.0	M6	13.0
S3191-06080	6.0	80.0	M6	13.0
S3191-08080	8.0	80.0	M8	17.0
S3191-08100	8.0	100.0	M8	17.0
S3191-10100	10.0	100.0	M10	21.0
S3191-12100	12.0	100.0	M12	25.0
S3191-12120	12.0	120.0	M12	25.0

Eye Nut

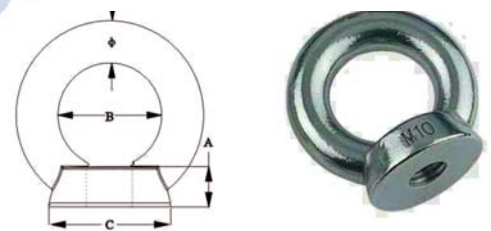

Code	Size	A	B	C
S582-0060	6	18.5	15.0	18.5
S582-0080	8	23.0	20.0	20.0
S582-0100	10	30.0	25.0	25.0
S582-0120	12	34.5	30.0	30.0
S582-0160	16	40.0	35.5	35.0
S582-0200	20	43.0	50.0	40.0
S582-0240	24	56.0	50.0	50.0

All thread



304 grade code	316 grade code	Size
SF7200	SF7230	M3
SF7202	SF7232	M4
SF7204	SF7234	M5
SF7206	SF7236	M6
SF7208	SF7238	M8
SF7210	SF7240	M10
SF7212	SF7242	M12
SF7214	SF7244	M16
SF7216	SF7246	M20
SF77067	SF7248	M24



Our in-house fabrication workshop cuts studs any size up to 3 meters!!

Dome nut



304 grade code	316 grade code	Size
SF2300	SF2330	M4
SF2302	SF2332	M5
SF2304	SF2334	M6
SF2306	SF2336	M8
SF2308	SF2338	M10
SF2310	SF2340	M12
SF2312	SF2342	M16
SF2314	SF23073	M20
	SF23074	M24

Flat washers

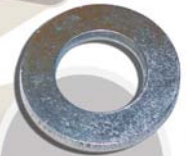

304 grade code	316 grade code	Size
SF5134		M5x10x.08mm
SF5136	SF5170	M6x12.5x1.2mm
SF5138	SF5172	M8x17x1.2mm
SF5140	SF5174	M10x21x1.2mm
SF5142	SF5176	M12x24x1.5mm
SF55008	SF56010	M14x28x1.5mm
SF5144	SF5178	M16x30x1.5mm
SF5146	SF5180	M20x37x2mm
SF55010	SF5182	M24x44x3mm
SF55011	SF5184	M30x56x3mm
	SF56012	M33x60x3mm
	SF5186	M36x66x5mm
	SF56013	M39x72x6mm
	SF5188	M42x78x5mm
	SF56014	M48x72x8mm

Hexagon nut



304 grade code	316 grade code	Size
SF22001		M1.6
SF22002	SF23001	M2
SF22003	SF23002	M2.5
SF2000	SF2050	M3
SF2002	SF2052	M4
SF2004	SF2054	M5
SF2006	SF2056	M6
SF2008	SF2058	M8
SF2010	SF2060	M10
SF2012	SF2062	M12
SF22005	SF23004	M14
SF2014	SF2064	M16
SF2016	SF2066	M20
	SF23006	M22
SF22007	SF2068	M24

Pop Rivets



304 grade code	Size
SF77901	4-2.
SF77902	4-3.
SF77903	4-4.
SF77905	4-6.
SF77906	4-8.
SF77908	5-2.
SF77909	5-3.
SF77910	5-4.
SF77912	5-6.
SF77913	5-8.

304 grade code	Size
SF77914	6-2.
SF77915	6-3.
SF77916	6-4.
SF77917	6-5.
SF77918	6-6.
SF77919	6-8.
SF77920	6-10.
SF77921	6-12.

Countersunk self tapper

304 grade code	316 grade code	Size
SF1014	SF4158	6GX1/2
SF4016	SF4160	6GX5/8
SF4018	SF4162	6GX3/4
SF4020	SF4164	6GX1
SF4022	SF4166	6GX1.1/4
SF4024	SF4168	6GX1.1/2
SF4030	SF4170	8GX3/8
SF4032	SF4172	8GX1/2
SF4034	SF4174	8GX5/8
SF4036	SF4176	8GX3/4
SF4038	SF4178	8GX1
SF4040	SF4180	8GX1.1/4
SF4042	SF4182	8GX1.1/2
SF4044	SF4184	8GX1.34
SF4046	SF45011	8GX2
SF4052	SF4186	10GX1/2
SF4054	SF45012	10GX5/8
SF4056	SF4188	10GX3/4
SF4058	SF4190	10GX1
SF4060	SF4192	10GX1.14
SF4062	SF4194	10GX1.1/2
SF4066	SF4196	10GX2
SF4068	SF45013	10GX2.1/2
SF4072	SF45014	12GX3/4
SF4074	SF4198	12GX1
SF4076	SF4200	12GX1.1/4
SF4078	SF4202	12GX1.1/2
SF4080	SF4204	12GX2
SF4082	SF45015	12GX2.1/2
SF4086	SF4206	14GX1
SF4090	SF4208	14GX1.1/2



Pan Head self tapper



304 grade code	316 grade code	Size
SF4264	SF4410	6GX1/2
SF4266	SF4412	6GX5/8
SF4268	SF4414	6GX3/4
SF4270	SF4416	6GX1
SF7272	SF4418	6GX1.1/4
SF4274	SF4420	6GX1.1/2
SF4282	SF4424	8GX1/2
SF4284	SF4426	8GX5/8
SF4286	SF4428	8GX3/4
SF4288	SF4430	8GX1
SF4290	SF4432	8GX1.1/4
SF4292	SF4434	8GX1.1/2
SF4296	SF4436	8GX2
SF4302	SF4438	10GX1/2
SF4304	SF4440	10GX5/8
SF4306	SF4442	10GX3/4
SF4308	SF4444	10GX1
SF4310	SF4446	10GX1.1/4
SF4312	SF4448	10GX1.1/2
SF4316	SF4450	10GX2
SF4318	SF45019	10GX2.1/2
SF4322	SF4452	12GX3/4
SF4324	SF4454	12GX1
SF4326	SF4456	12GX1.1/4
SF4328	SF4458	12GX1.1/2
SF4330	SF4460	12GX2
SF4332	SF4462	12GX2.1/2
SF4336	SF4464	14GX3/4
SF4338	SF4466	14GX1
SF4342	SF4470	14GX1.1/2
SF4344	SF4472	14GX2

Hex coach screws



304 grade code	Size	304 grade code	Size
SF1880	M6X30	SF1904	M10X40
SF1882	M6X40	SF1906	M10X50
SF1884	M6X50	SF1908	M10X65
SF1886	M6X65	SF1910	M10X75
SF1888	M6X75	SF1912	M10X100
SF1890	M6X100	SF1914	M10X120
SF12216	M6X120	SF12217	M10X150
SF1892	M8X30	SF1916	M12X50
SF1894	M8X40	SF1918	M12X65
SF1896	M8X50	SF1920	M12X75
SF1898	M8X65	SF1922	M12X100
SF1900	M8X75	SF1924	M12X120
SF1902	M8X100	SF12218	M12X130

Bugle Batten screw

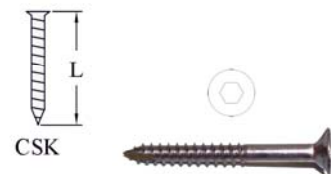

304 grade code	Size
SF44001	14GX50
SF44002	14GX75
SF44003	14GX100

Hex head bolts

304 grade code	316 grade code	Size
SF1000	SF1110	M6X30
SF11001	SF1112	M6X35
SF1002	SF1114	M6X40
SF11002	SF1116	M6X45
SF1004	SF1118	M6X50
SF11003	SF1120	M6X55
SF11004	SF1122	M6X60
SF11006	SF1126	M6X70
SF11007	SF1128	M6X75
SF11008	SF1130	M6X80
SF11009	SF1132	M6X90
SF11010	SF1134	M6X100
SF11011	SF1138	M6X130
SF11012	SF1140	M6X150
SF11014	SF1142	M8X35
SF1006	SF1144	M8X40
SF11015	SF1146	M8X45
SF1008	SF1148	M8X50
SF11016	SF1150	M8X55
SF1010	SF1152	M8X60
SF1012	SF1154	M8X65
SF1014	SF1156	M8X70
SF1016	SF1158	M8X75
SF11017	SF1160	M8X80
SF11018	SF1162	M8X90
SF1018	SF1164	M8X100
SF11020	SF1168	M8X130
SF11021	SF1170	M8X150
SF11023	SF1172	M10X40
SF11024	SF1174	M10X45
SF1020	SF1176	M10X50
SF11025	SF1178	M10X55
SF1022	SF1180	M10X60
SF1024	SF1182	M10X65
SF11026	SF1184	M10X70
SF1026	SF1186	M10X75
SF1028	SF1188	M10X80
SF1030	SF1190	M10X90
SF1032	SF1192	M10X100
SF11027	SF1194	M10X110
SF1034	SF1196	M10X120
SF11028	SF1198	M10X130
SF11029	SF12001	M10X140
SF11030	SF1200	M10X150
SF11032	SF1202	M12X45
SF1036	SF1204	M12X50
SF10033	SF1206	M12X55
SF1038	SF1208	M12X60



304 grade code	316 grade code	Size
SF1040	SF1210	M12X65
SF1042	SF1212	M12X70
SF1044	SF1214	M12X75
SF1046	SF1216	M12X80
SF1048	SF1218	M12X90
SF1050	SF1220	M12X100
SF11034	SF1222	M12X110
SF1052	SF1224	M12X120
SF1054	SF1226	M12X130
SF11035	SF12009	M12X140
SF1056	SF1228	M12X150
SF11036	SF12010	M12X160
SF11037	SF12031	M16X50
SF1058	SF1230	M16X55
SF1060	SF1232	M16X60
SF1062	SF1234	M16X65
SF1064	SF1236	M16X70
SF1066	SF1238	M16X75
SF1068	SF1240	M16X80
SF1070	SF1242	M16X90
SF1072	SF1244	M16X100
SF1074	SF1246	M16X110
SF1076	SF1248	M16X120
SF1078	SF1250	M16X130
SF11038	SF12032	M16X140
SF1080	SF1252	M16X150
SF11039	SF12033	M16X160
SF11041	SF1254	M20X60
SF1082	SF1256	M20X65
SF1084	SF1258	M20X70
SF1086	SF1260	M20X75
SF11042	SF1262	M20X80
SF1088	SF1264	M20X90
SF1090	SF1266	M20X100
SF1092	SF1270	M20X120
SF1094	SF1272	M20X130
SF1096	SF1274	M20X150
SF11043	SF1280	M24X80
SF11044	SF1282	M24X90
SF11045	SF1284	M24X100
SF11046	SF1286	M24X110
SF11047	SF1288	M24X120
SF11048	SF1290	M24X130
SF11049	SF120511	M24X140
SF11050	SF1292	M24X150

Many more Stainless fasteners available, all sizes and grades!!

Flapper Discs

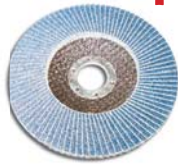

Code Zirconium	Size	Grit	Max. RPM	Box Qty
FDZ4-36	4"(100mm)	36	15200	10
FDZ4-60	4"(100mm)	60	15200	10
FDZ4-80	4"(100mm)	80	15200	10
FDZ5-36	5" (125mm)	36	12200	10
FDZ5-60	5" (125mm)	60	12200	10
FDZ5-80	5" (125mm)	80	12200	10

Velcro Sanding Disc

Code Alumina	Size	Grit	Max. RPM	Box Qty
SDVA5-120	5" (125mm)	120	12200	100
SDVA5-240	5" (125mm)	240	12200	100
SDVA5-400	5" (125mm)	400	12200	100

Velcro Sanding Pad

Code Alumina	Size	Grit	Max. RPM	Box Qty
SDVA5-PAD	5" (125mm)	Base Pad Only		1

Grinding Disc



Code	Size	Hole Size	Max. RPM	Box Qty
GD101	4" (100mm) x 4.5mm	16	15200	25
GD125	5" (125mm) x 6mm	22.2	12200	25
GD230	9" (230mm) x 6.0mm	22.2	6600	25



Inox Cut Off Wheels

Code	Size	Hole Size	Max. RPM	Box Qty
CD125	4" (100mm) x 1mm	16	12200	50
CD230	5" (125mm) x 1mm	22.2	12200	50
CD350	9" (230mm) x 1mm	22.2	6600	50

Linishing belts



Pump up wheel belt



Code Zirconium	Code Alumina	Size	Grit	Box Qty
LBZ914x50-36		914x50	36	10
LBZ914x50-60		914x50	60	10
LBZ914x50-80		914x50	80	10
	LBA914x50-120	914x50	120	10
	LBA914x50-240	914x50	240	10
	LBA914x50-400	914x50	400	10

Code Zirconium	Code Alumina	Size	Grit
PUWBZ400x90-60		400x90	60
PUWBZ400x90-80		400x90	80
	PUWBA400x90-120	400x90	120
	PUWBA400x90-240	400x90	240
	PUWBA400x90-400	400x90	400

Scotch brite Linishing belts



Pump up wheel Scotch brite belts



Code	Size	Grit	Box Qty
LBSBROWN	914x50	Coarse	6
LBSRED	914x50	Medium	6
LBSBLUE	914x50	Fine	6

Code	Size	Grit	Box Qty
PUWBSBROWN	400x90	Coarse	3
PUWBSRED	400x90	Medium	3
PUWBSBLUE	400x90	Fine	3

Pump up wheel Spares



Code	Description	Suit belts
PUWT90	Tire only	400x90
PUWTH90	Tire and Hub	400x90

Stitched sisal mops bright yellow treated



Code	Size	Sections
CSC1	8" x 7mm	1/2 section
CSC1	8" x 13mm	1 section
CSC2	8" x 25mm	2 section
CSC4	8" x 50mm	4 section

Stitched cloth mops, stiff cloth type B



Code	Size	Sections
CSX1/2	8" x 7mm	1/2 section
CSX1	8" x 13mm	1 section
CSX2	8" x 25mm	2 section
CSX4	8" x 50mm	4 section

Loose Leaf cloth mops without impregnation

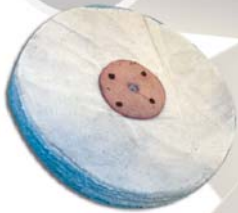

Code	Size	Leafs
CLM	8" x 25mm	25 leafs
CLM	8" x 50mm	50 leafs

Polish



Code	Type
PHFW	Hyper Fin White



Code	Type
PFCB	Fast cut Black



Chemset

Code	Size	Pack Qty
CHEMSET	420ml	2

Safety Glasses



Code	Size	Box Qty
SG	1 size fits all	12

Epoxy Quickset Grout



Code	Size	Pack Qty
GROUT	20kg	1

Safety Masks - Pf2



Code	Size	Standard	Box Qty
SGSMPF2	1 size fits all	PF2	10

Sikaflex



Code	Size	Pack Qty
SIKA	310ml	1

Gloves



Code	Size	Material	Box Qty
SGLO	1 size fits all	Cow Hide	10

Glazing Silicone



Code	Size	Pack Qty
GSB	310	1

Ear plugs



Code	Size	Box Qty
EP	1 size fits all	10



ATLAS STAINLESS SUPPLIES pty Ltd

the leaders in supply of true grit finished stainless

Notching Service



- *Tube notching to 100mm
- *Round tube
- *Square tube
- *Rectangle tube

- *Flat bar
- *Round bar
- *Square bar
- *Achieve professional finish

Plasma Cutting



- *Stainless Steel Cutting up to 16mm thickness
- *In-house Auto cad processing
- *Sheet cutting up to 3000mm x 1500mm
- *All material types

Our Fabrication Shop



TAKING METALS TO THE NEXT LEVEL

- Specialists in all Stainless Fabrications
- Aluminium Balustrading & Handrails
- Stainless Balustrading and handrails
- Stainless Wire Balustrading
- Boat rails, Pushpit/Pullpits
- Architectural Fabrications
- Glass Balustrading
- CNC Plasma Cutting
- Flat bar and Tube polishing
- Gates
- Electric Gates
- Screens

Commercial-Residential-Domestic



Affiliated company



35 Manton St
Bullimba Qld 4171
www.atlaschains.com.au

Ph: 07 3899 2933
Fax: 073899 2976
atlas@uq.net.au

- *All grades & Sizes of chain
- *Wire rope & wire rope slings
- *Marine equipment
- *Nylon, silver, manila & polypropylene ropes

- *All lifting equipment
- *Stainless steel balustrading and fittings
- *All tie down lashing equipment
- ***NATA Approved testing facility**

1800 999 885



ATLAS STAINLESS SUPPLIES pty Ltd



PH: 07 5593 4744

Fax: 07 5593 6205

6 Kimberley Rd

Burleigh Gardens Qld 4220

the leaders in supply of true grit finished stainless

www.atlasstainless.com.au

The Fabricators Handbook

The Fabricators Handbook